

STATE OF INDIANA
DEPARTMENT OF NATURAL RESOURCES
INDIANA HISTORIC SITES AND STRUCTURES INVENTORY

1. HISTORIC NAME FURNITURE BLDG.
2. OWNERSHIP: PUBLIC ☒ PRIVATE
NAME Hulman & Co.
ADDRESS _____
3. LOCATION NOTES Donation Enlg. Lot 212
(20-26-7)
4. VISIBLE FROM PUBLIC RIGHT OF WAY: ☒ YES ☐ NO

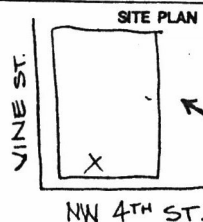

IDENTIFICATION

5. USE PRESENT PAST 6. CATEGORY 8. ENDANGERED
Residential (sing.) ☐ DISTRICT ☒ NO
Residential (mult.) ☐ ☐ YES/BY WHAT _____
Commerce ☒ ☒ ☒ BUILDING(S)
Industrial ☐ ☐ STRUCTURE
Agriculture ☐ ☐ SITE
Transportation ☐ ☐ OBJECT
Organization ☐ ☐
Military ☐ ☐
Political ☐ ☐
Unknown ☐ ☐
Vacant ☐ ☐
Other OFFICES ☒ ☒
7. ACCESSIBLE 9. DATE 1908
☒ YES/RESTRICTED 10. ARCHITECT/BUILDER
☐ YES/UNRESTRICTED CLIFFORD
☐ NO SHOPBELL

CLASSIFICATION/DATE

11. PERIODS: PREHISTORIC 17TH/18TH CEN. 1800-1880 1881-1899 ☒ 1900-PRESENT

12. AREAS OF SIGNIFICANCE

<input type="checkbox"/> Archeology-Prehistoric	<input type="checkbox"/> Conservation	<input type="checkbox"/> Law	<input type="checkbox"/> Sculpture
<input type="checkbox"/> Archeology-Historic	<input type="checkbox"/> Economics	<input type="checkbox"/> Literature	<input type="checkbox"/> Social/Humanitarian
<input type="checkbox"/> Agriculture	<input type="checkbox"/> Education	<input type="checkbox"/> Military	<input type="checkbox"/> Theater
<input checked="" type="checkbox"/> Architecture	<input type="checkbox"/> Engineering	<input type="checkbox"/> Music	<input type="checkbox"/> Transportation
<input type="checkbox"/> Art	<input type="checkbox"/> Exploration/Settlement	<input type="checkbox"/> Philosophy	<input type="checkbox"/> Other (Specify)
<input checked="" type="checkbox"/> Commerce	<input type="checkbox"/> Industry	<input type="checkbox"/> Politics/Government	
<input type="checkbox"/> Communications	<input type="checkbox"/> Invention	<input type="checkbox"/> Religion	
<input type="checkbox"/> Community Planning	<input type="checkbox"/> Landscape Architecture	<input type="checkbox"/> Science	

SIGNIFICANCE

13. STYLE 14. CONDITION 16. SITE INTEGRITY
☐ Federal ☐ EXCELLENT ☒ ORIGINAL SITE
☐ Greek Revival ☒ GOOD ☐ MOVED DATE _____
☐ Gothic Revival ☐ FAIR
☐ Italianate ☐ DETERIORATED
☐ Second Empire ☐ RUINS ☒ NO
☐ Stick Style/Eastlake ☐ UNEXPOSED ☐ YES
☐ Queen Anne
☐ Romanesque Revival
☐ Colonial Revival
☐ Neo-Classical
☐ Bungalow
☐ Vernacular
☒ Other (Specify) BEAUX ARTES

DESCRIPTION

15. ALTERATIONS 17. OUTBUILDINGS/SECONDARY STRUCTURES 18. IN ESTABLISHED HISTORIC DISTRICT
☐ UNALTERED ☒ NO
☐ MINOR ☐ YES/NAME _____
☐ MAJOR

19. DESCRIPTION OF ENVIRONMENT (NATURAL AND MAN-MADE) COMMERCIAL- DOWNTOWN
ACROSS FROM OLD COUNTY COURTHOUSE. OLD STREETLIGHTS
STILL EXIST ALONG THIS BLOCK (BUT NOT CONTEMPORARY WITH
BUILDING) REMODELED 1940.

20. INFORMATION SOURCES TOWNSHIP ASSESSOR; JACK WESLEY TYPED INDEX

21. PREPARED BY NANCY J. LONG 22. DATE 9/25/77

1. C RECTANGULAR PLAN
2. F 6 STORIES, 7 ON FRONT SECTION
3. E 5 BAYS
4. E 1ST FLOOR STONE (MAIN SECTION) OTHERWISE STRETCHER BOND YELLOW BRICK
5. B-3 STRING COURSE (STONE); B-5 STONE PLINTH
6. A-1 RECESSED PANELS; A-3 ENGAGED PIERS; B-2 STONE ENTABLATURE
7. F NO PORCH. STAIRWAY DOWN ~~FROM~~ IN SIDEWALK, W/ FENCE.
8. A UNKNOWN ROOFING
9. J PROBABLY FLAT. SERVICE STRUCTURES ON TOP.
10. A INTERIOR CHIMNEYS
11. B BRICK
12. J NO DORMERS
13. L PARAPET
14. B STONE
15. R NONE
16. I NONE
17. C-A NONE
18. A FLAT WINDOWS
19. F-1 ENTABLATURE
20. A PLAIN SIDES
21. B STONE
22. A STONE SILL
23. A FIXED SASH DISPLAY-TYPE WINDOWS W/ FIXED TRANSOM MODERN
24. A-1
25. B UPPER FLOORS DOBBLEHUNG. THIRD FLOOR + ABOVE HAVE BRICK SURROUNDS
26. B-1 CENTRAL ENTRANCE
27. A FLAT OPENING
28. F-2 BRACKETED PEDIMENT
29. A PLAIN SIDES
30. B STONE
31. A-2 PLAIN W/ DEEP REVEAL
32. ALTERED
33. _____
34. _____
35. C. INTERIOR UNKNOWN

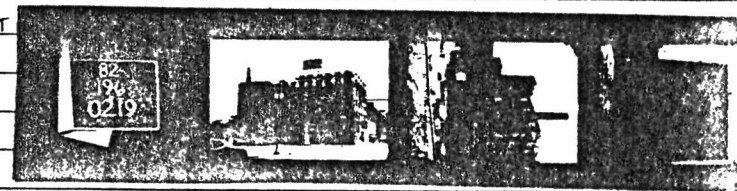

Architectural Information

STATE OF INDIANA
DEPARTMENT OF NATURAL RESOURCES
INDIANA HISTORIC SITES AND STRUCTURES INVENTORY

Additional Architectural Information

A. NAME Court Building C. NUMBER 82-196-0219

B. ADDRESS 123-25 NW Fourth Street

D. UTM References 16 449740 4202810

E. This office skyscraper was conceived as an "exchange building" for the city's furniture manufacturers and dealers. Evansville was nearing the peak of its hardwood industry when the Furniture Building (later renamed the Court Building, probably in reference to the nearby Courthouse) was completed in 1909. Its designer, Harris & Shopbell, selected a yellow buff brick which was considerably cheaper than using strictly limestone on the exterior. Shopbell & Company (the successor to Harris & Shopbell after Harris' death in 1910) occupied the top floor as its studio. The trade association responsible for pushing through the construction project included Benjamin Bosse in its leadership. Bosse was a prominent furniture manufacturer who would ascend to the mayor's office in 1913, serving until his untimely death during his third term in 1922. Shopbell & Company came to be Bosse's favorite architectural firm, performing a good deal of public work during the Bosse administration and designing the mayor's own Prairie School bungalow on SE First Street in 1916.

F. INFORMATION SOURCES City Directories. Architectural Renderings, Jack Wesley. Evansville Courier, 28 April 1908.

G. PREPARED BY Douglas L. Stern H. DATE 22 December 1981

NATIONAL REGISTER OF HISTORIC PLACES

United States Department of the Interior
National Park Service

EVALUATION / RETURN SHEET *(Downtown Evansville MRA)*

Property: Court Building (Furniture Building)
State, County: IN, Evansville Vanderburgh
Federal Agency: _____

Working No. 5620192-1506
Fed. Reg. Date: 2.1.83
Date Due: 6/27/82 - 7-4-82

Action: ☒ ACCEPT 7/1/82
Entered in the _____
National Register ☐ RETURN _____
☐ REJECT _____
photos _____
maps _____

☐ resubmission
☐ nomination by person or local government
☐ owner objection
☐ appeal

Substantive Review: ☐ sample ☐ request ☐ appeal ☐ NR decision

Reviewer's comments:

Recom./Criteria _____
Reviewer _____
Discipline _____
Date _____
☐ see continuation sheet

Nomination returned for: ☒ technical corrections cited below
☐ substantive reasons discussed below

1. Name

2. Location

3. Classification

Category	Ownership	Status	Present Use
	Public Acquisition	Accessible	

4. Owner of Property

5. Location of Legal Description

6. Representation in Existing Surveys

has this property been determined eligible? ☐ yes ☐ no

7. Description

Condition	Check one	Check one
<input type="checkbox"/> excellent	<input type="checkbox"/> deteriorated	<input type="checkbox"/> original site
<input type="checkbox"/> good	<input type="checkbox"/> ruins	<input type="checkbox"/> moved
<input type="checkbox"/> fair	<input type="checkbox"/> unexposed	<input type="checkbox"/> date _____

Describe the present and original (if known) physical appearance

☐ summary paragraph
☐ completeness
☐ clarity
☐ alterations/integrity
☐ dates
☐ boundary selection

8. Significance

Period _____ Areas of Significance—Check and justify below

Specific dates _____ Builder/Architect _____

Statement of Significance (in one paragraph)

- _____ summary paragraph
- _____ completeness
- _____ clarity
- _____ applicable criteria
- _____ justification of areas checked
- _____ relating significance to the resource
- _____ context
- _____ relationship of integrity to significance
- _____ justification of exception
- _____ other

9. Major Bibliographical References

10. Geographical Data

Provide acreage
Acreage of nominated property _____
Quadrangle name _____
LMT References _____

Verbal boundary description and justification _____

11. Form Prepared By

12. State Historic Preservation Officer Certification

The evaluated significance of this property within the state is

_____ national _____ state _____ local

State Historic Preservation Officer signature _____

Site _____ date _____

13. Other

- _____ Maps
- _____ Photographs
- _____ Other

Questions concerning this nomination may be directed to _____

Signed _____ Date _____ Phone: 202 272-3504

Comments for any item may be continued on an attached sheet



DOWNTOWN EVANSVILLE RESOURCES
Vanderburgh County, Indiana
N. Long, DMD 1977

#33: view southeast of
123-25 N.W. Fourth St.

Please refer to the map in the
Multiple Property Cover Sheet
for this property

Multiple Property Cover Sheet Reference Number: 64000186