

SEC.DIA.("M")	"C"
60"	6'-0"
72"	7'-2"
96"	9'-6"
102"	10'-1"
108"	10'-8"

SEC.DIA.("M")	"B"
60"	6'-0"
72"	7'-2"
96"	9'-6"
102"	10'-1"
108"	10'-8"

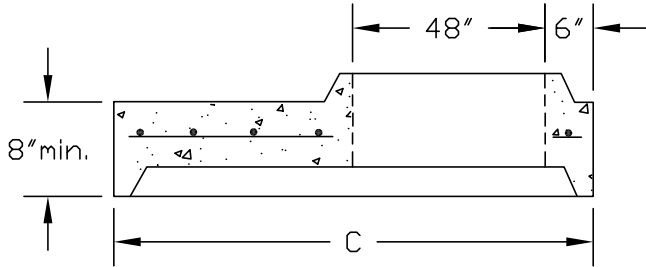

SIDE VIEW

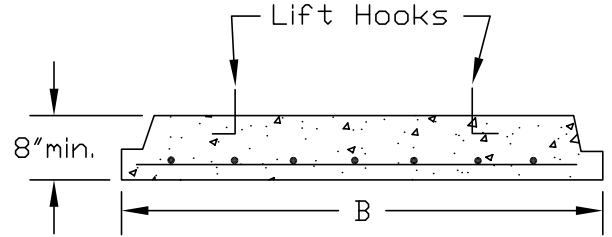

SIDE VIEW

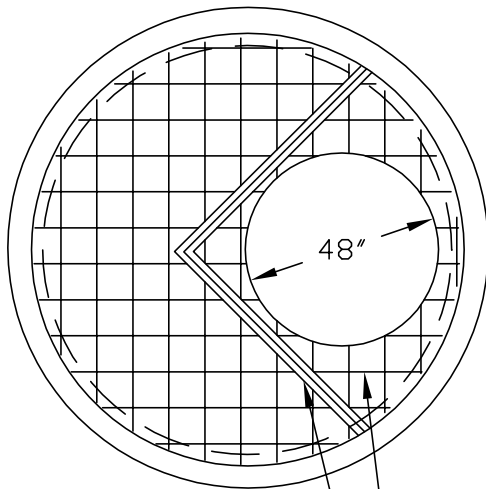

Opening additionally reinforced with equivalent of 0.20 sq.in./L.Ft. @ 90

Straight Rods, min. length = Dia. of opening plus 2 in.

Minimum Steel area 0.12 sq.in./L.Ft. of width in both directions

TOP VIEW

P.C.C. 4000psi

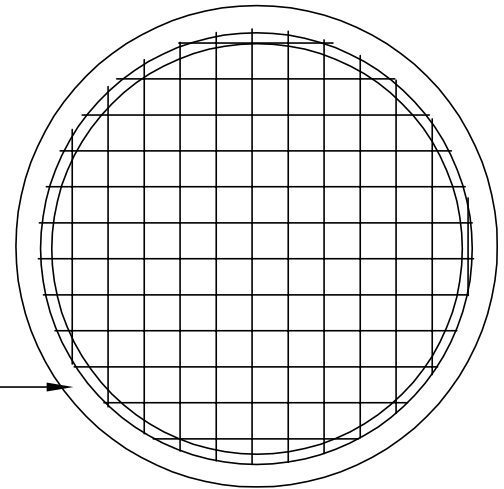

Minimum Steel area 0.12 sq.in./L.Ft. of width in both directions. Rebar or wire mesh equivalent.

TOP VIEW

REDUCER CAP FOR PRE-CAST MANHOLE SECTIONS 60" TO 108" DIA.

BASE FOR PRE-CAST MANHOLE SECTIONS 60" TO 108" DIA.

DETAIL C-1b

Circular Manhole for 24" to 84" Diameter Pipes
No Scale (Rev. Date 10/31/97)