

Jeff Mueller, Vanderburgh County Surveyor
www.VanderburghSurveyor.com

Prepared By: Linda Freeman
Vand Co Surveyor's Office
812-435-5210

Regulated Drains Located in Eastern Vanderburgh County, Indiana

Regulated Drains Located in Northeastern Vanderburgh County, Indiana

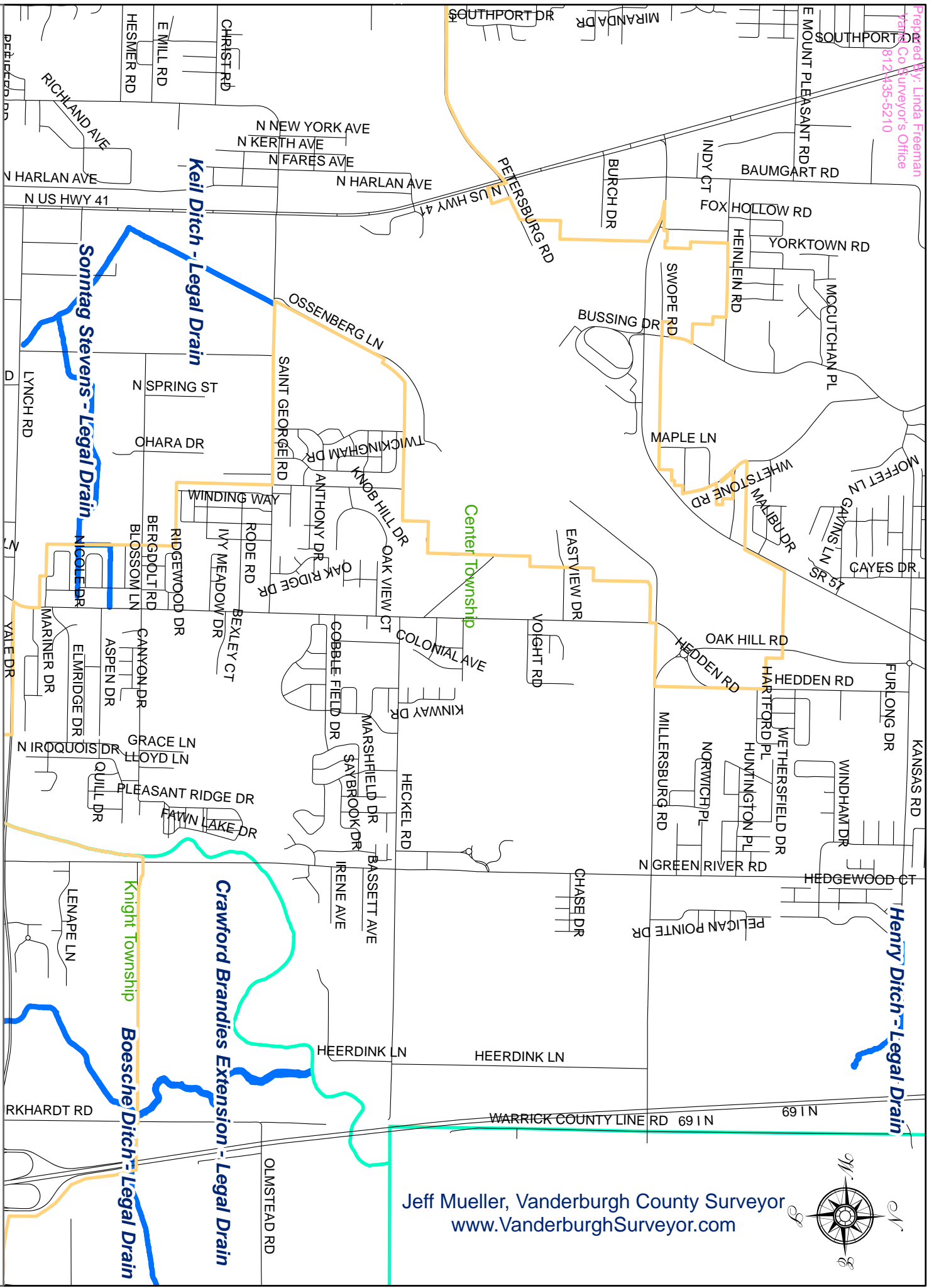

Jeff Mueller, Vanderburgh County Surveyor
www.VanderburghSurveyor.com

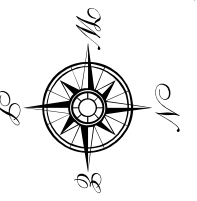

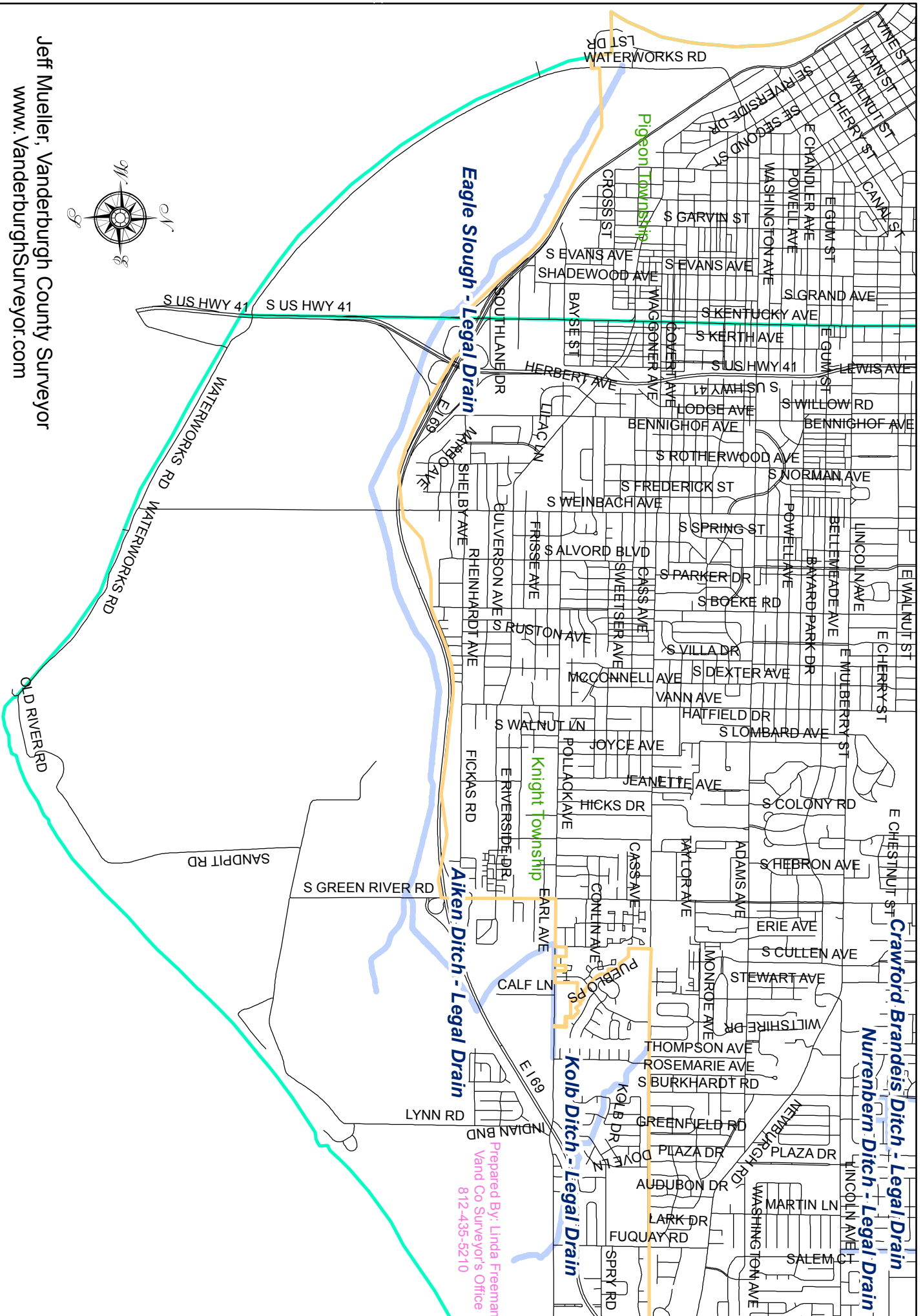

Prepared By: Linda Freeman
 Vand Co Surveyor's Office
 812-435-5210

Jeff Mueller, Vanderburgh County Surveyor
 www.VanderburghSurveyor.com

Regulated Drains Located in Southeast Vanderburgh County, Indiana

WEST FRANKLIN RD
WOODLAND LAKE RD
Perry Township
Bayou Creek



Jeff Mueller, Vanderburgh County Surveyor
www.VanderburghSurveyor.com

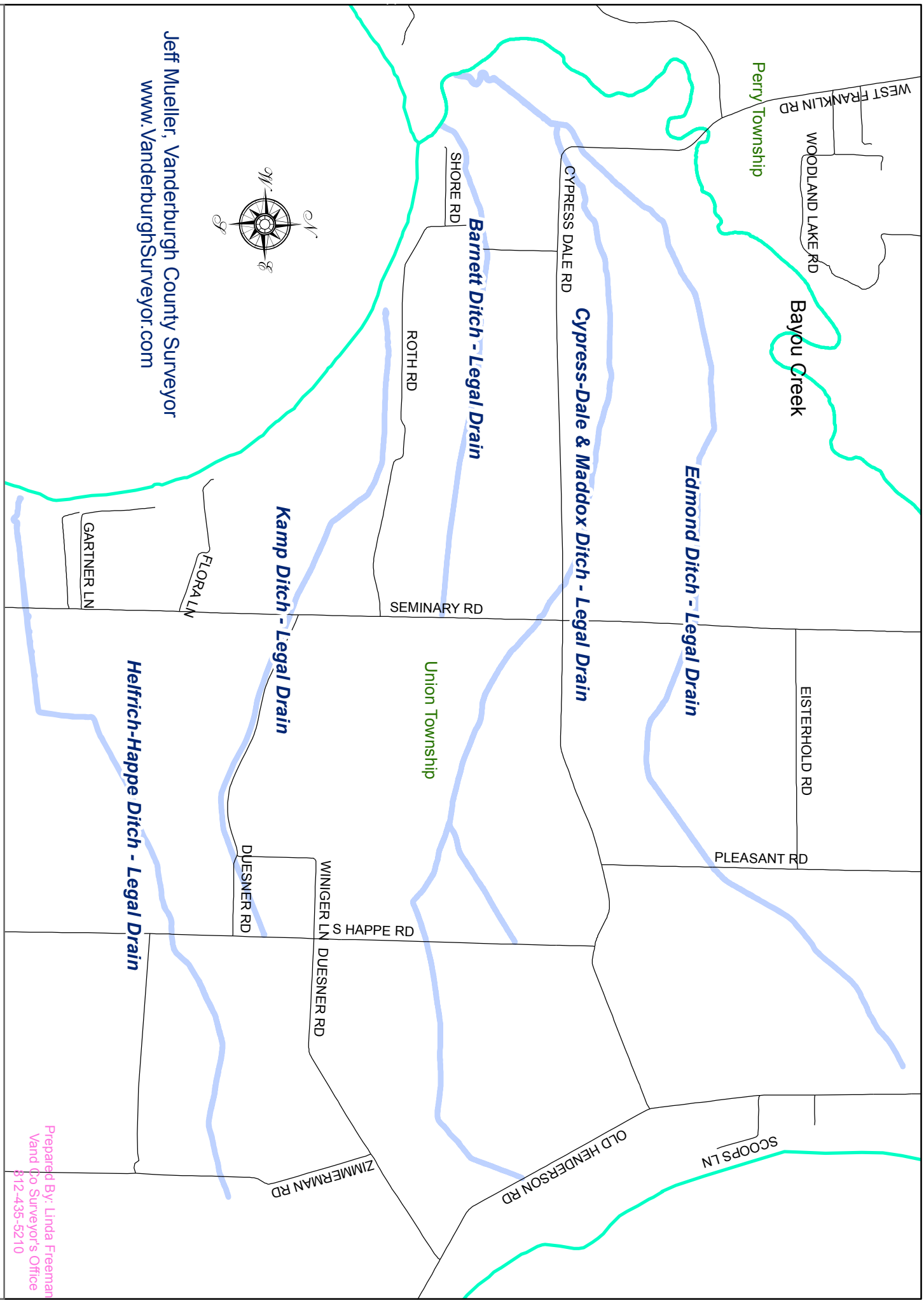

Regulated Drains Located in Union Township Vanderburgh County, Indiana

Prepared By: Linda Freeman
Vand Co Surveyor's Office
812-435-5210



Regulated Drains Located in Northwest Vanderburgh County, Indiana

Jeff Mueller, Vanderburgh County Surveyor
www.VanderburghSurveyor.com

Prepared By: Linda Freeman
 Vand Co Surveyor's Office
 812-435-5210

